

# King Charles I School



## Sixth Form Open Evening

Thursday 7<sup>th</sup> November 2019

6.00pm – 8.00pm on the Hillgrove site

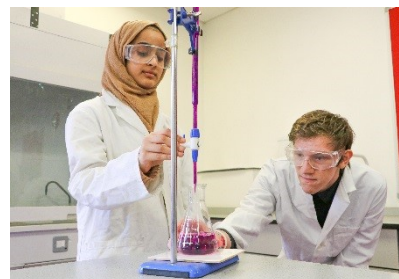

There will be a short presentation at 6:15pm in the Oldfield Hall delivered by:

- Stephen Brownlow (headteacher)
- Ruth Allen (deputy headteacher)
- Bev Blackburn (head of sixth form)
- Adam Turley (head boy) and Jasmine Morris (head girl) and their team

Refreshments, by Cattleya our student business, will be available in the café next to the Oldfield hall. Please sign in in our sixth form study room, see what facilities we have to offer and meet some of our current students. Students and parents/carers are welcome to visit subject stands between 6pm and 8.00pm.

# Courses on offer

## **A Levels courses**

Art and Design  
Biology  
Business  
Chemistry  
Computer Science  
Economics  
English Language & Literature  
English Language  
English Literature  
French  
Geography  
German  
Government and politics  
History  
Law  
Mathematics  
Mathematics (Further)  
Media Studies  
Music  
Music Technology  
Physics  
Psychology  
Physical Education  
Photography  
Product Design  
Religious Studies  
Sociology  
Spanish

## **Vocational courses**

Applied Science  
Applied Business  
Criminology  
Engineering  
Food Technology  
ICT  
Sport  
Health and social care  
Hospitality  
Psychology

## Sixth form open evening programme

<b>Subject</b>	<b>Activity</b>	<b>Room</b>
Art/photography	Come along and find out more about the courses and discuss with current students.	R6
Biology	Come along and find out more about how studying biology can lead to many different science professions	R3
Business studies	Business brains – have you got what it takes? Try our interactive game and quiz to find out.	R5
Chemistry	Come and learn more about the course and assessed practicals.	R1
Computer science	Sorting algorithms and games logic programming with battleships.	TP1
English	Why English Language and Literature is the real deal – exploring how writers present real and imagined experience.	R2
French	Come along and see where French can take you. Find out about the course requirements as well as details about French A Level.	R4
Geography	Where in the world interactive quiz and other interesting geographical facts.	W7
German	Come along and see where German can take you. Find out about the course requirements as well as details about German A Level.	R4
Government and politics	'Who should I vote for?' Complete a quiz to help decide who to vote for	W7
Health and social care	Try your hand at practical activities based on human lifespan development.	R7
History	Complete a quirky historical quiz.	W7
Hospitality	Come and check out what this course entails.	R3
Law	Read about high-profile, local and recent legal cases! Also, an opportunity to get a taster of the content you will be studying as an A-Level Law student- peruse student folders and look at the materials we use.	W2
Maths	Come along and find out about the A-level mathematics and further mathematics course. Find out about possible career routes involving mathematics.	W2
Media	Come along and find out what a course in media is all about.	R2
Music	Come along and find out more about what this course has to offer.	R6
RE	Consider what is meant by 'evil'.	R5
BTEC sport	Meet Eric and label the muscle man.	R7
Physics	Come and learn about the course content and the optional astrophysics unit.	R9
Product design	Try your hand at wood turning and other timber based activities. Check out our Year 13's projects.	TP1
Psychology	Come along and find out what the course is about.	R3
Transition year	Meet with our Y12 transition year students and find out about their courses and work experience	Sixth form study centre

# Your guide to subjects for the Sixth-Form Information Evening

Please feel free to visit subjects in any order you choose. The plans below show you the location of the different subjects.

## Renwick:

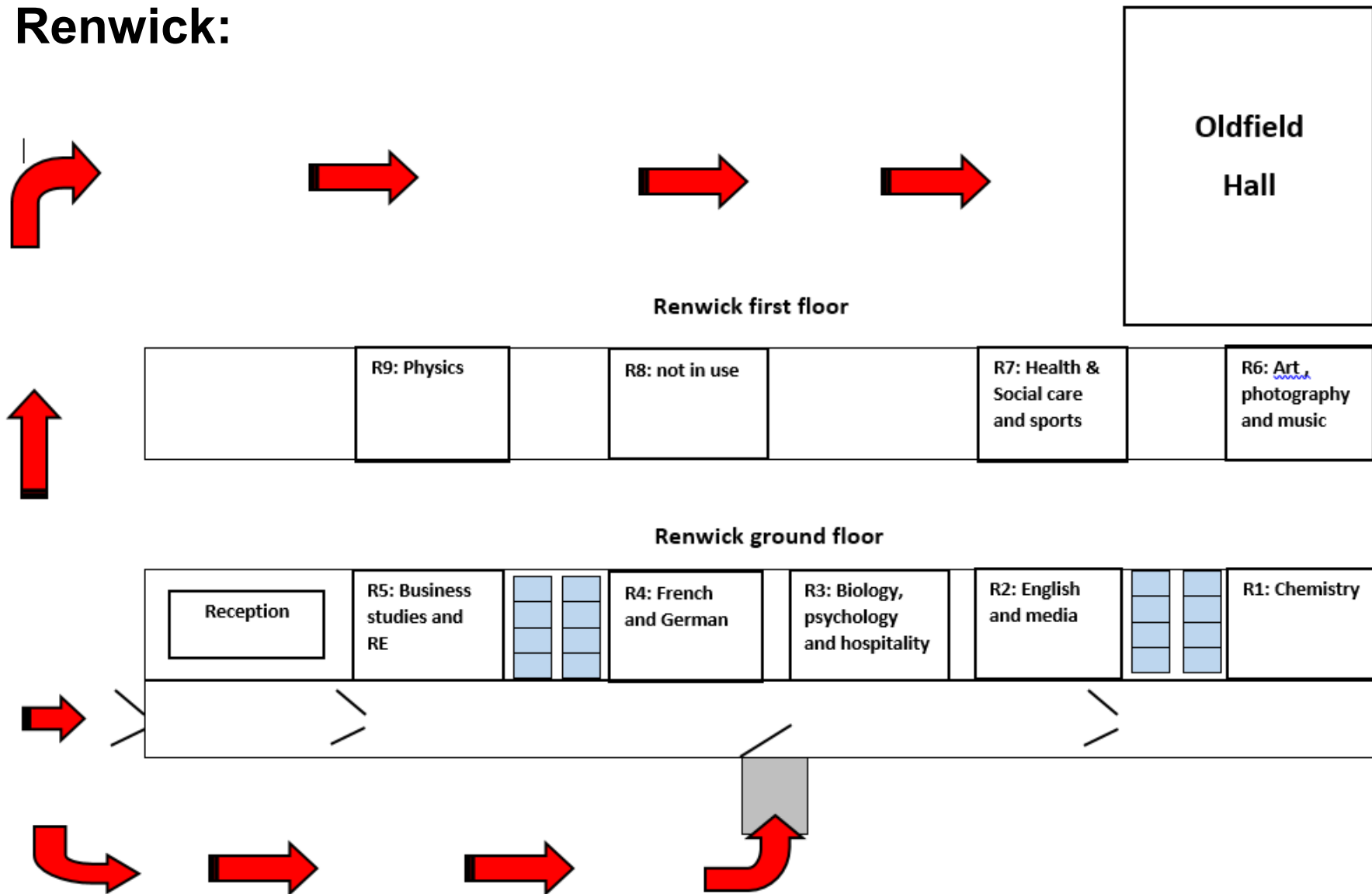

# Woodward:

## Woodward first floor

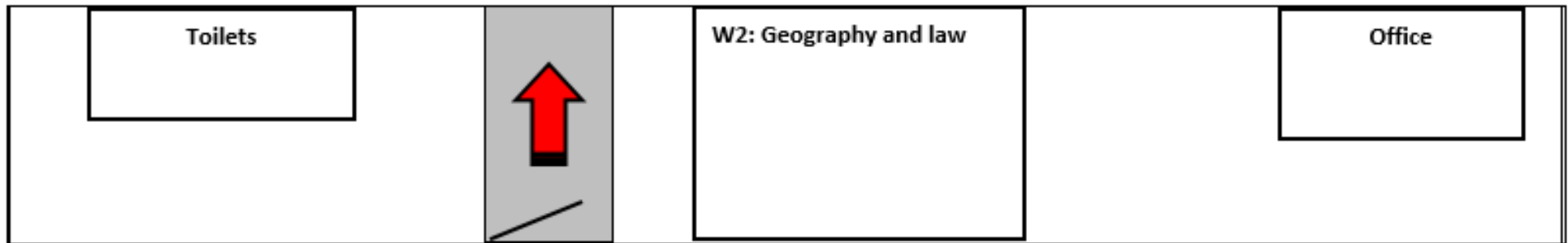
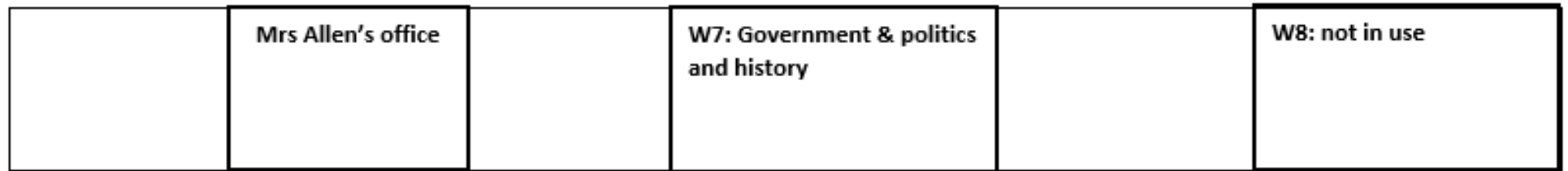
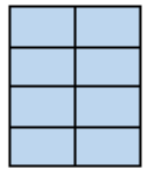
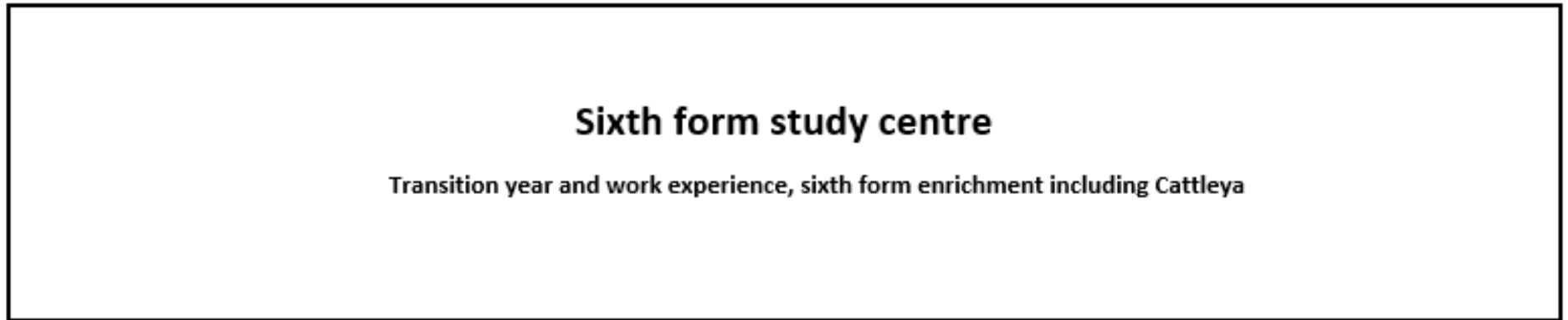

ENTER WOODWARD  
BUILDING

# Technology Pavilion:

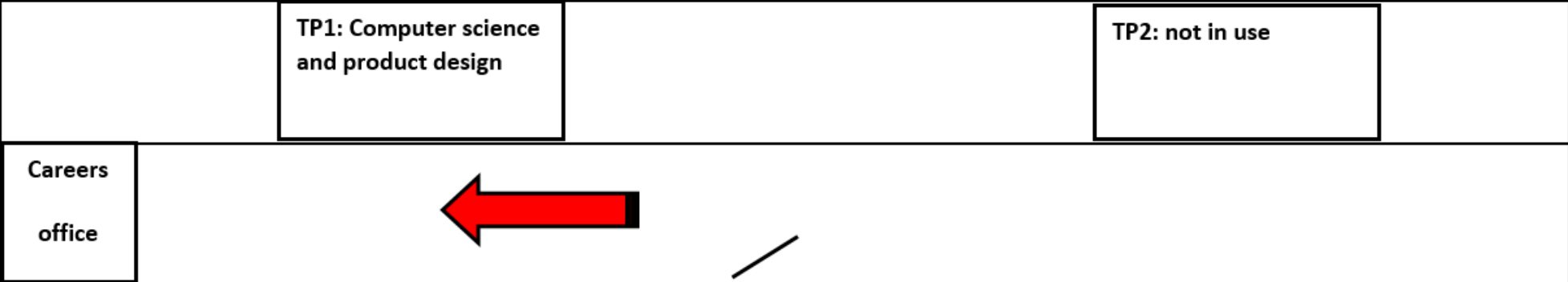

ENTER TP BUILDING